

HIVE WOOD

Output (kw)	13kW	17kW
Sauna room min. (m³)	6	8
Sauna room max. (m³)	13	16
Weight of stones (kg)	90	130
Height (mm)	750	750
Width (mm)	455	555
Depth (mm)	460	590/740 ^{LS}
Weight (kg)	45	85
Firewood max. (mm)	300	400
Flue Ø (mm)	115	115
C (mm)	240	300
D (mm)	425	460
E (mm)	5	35/185 ^{LS}

SAFETY CLEARANCE*

A (mm)	500	500
B (mm)	1000	1000

LS - through the wall

* - Combustible materials

- A high-quality firebox ensures the long service-life of the heater.
- Flame cutters are made from special heat-resistant steel.
- The firebox extension also allows the stove to be heated from another room.
- Additionally, we offer a heat exchanger that can be used for heating water. Connections are of 1/2" male thread. The heat exchanger can be installed behind the firebox or on its sides.

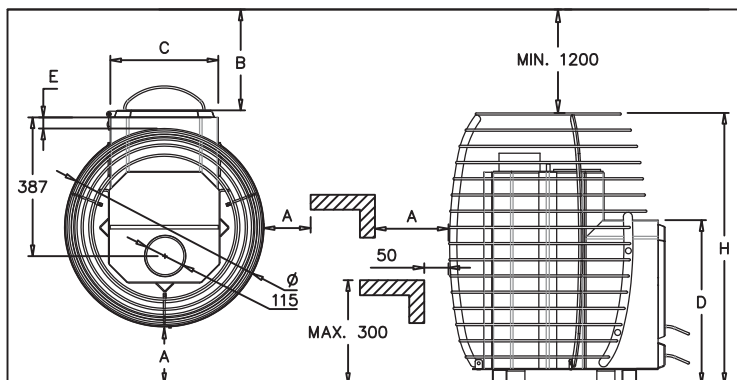

WWW.HUUM.EU

DISTRIBUTOR:

DELIVERY TIME / TERMS AND CONDITIONS (TO BE AGREED WHEN PLACING AN ORDER)

A WOOD-FIRED
HEATER REFLECTS
**THE PURE
NORDIC DESIGN
LANGUAGE OF
HUUM AND THE
WISDOM OF
BUILDING A
SAUNA HEATER.**
A LARGE NUMBER
OF STONES
PROVIDES VARIED
AND LONG
LASTING STEAM.



SAUNA HEATER
HIVE WOOD

HIVE WOOD 17 KW - ART. 4744103015009
HIVE WOOD LS 17 KW - ART. 4744103015054



New product

WWW.HUUM.EU INFO@HUUM.EU

© ALL RIGHTS RESERVED - HUUM 2018