

2.

One Soft-close hinge "L"
should be used
per one door

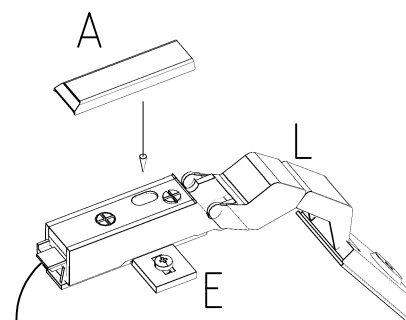

Door closing damping
adjustment knob only on
"L" hinge

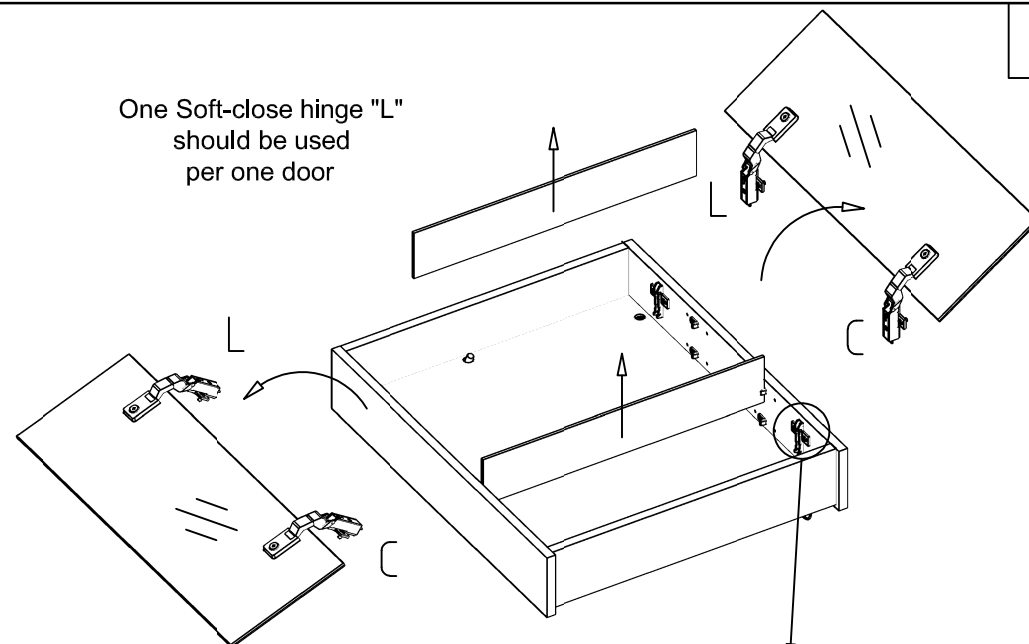
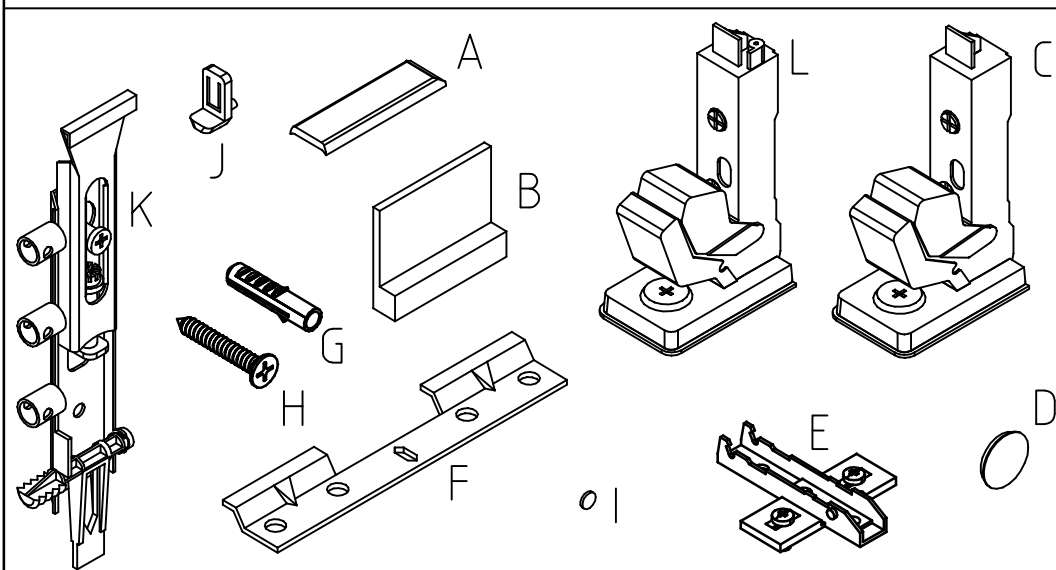
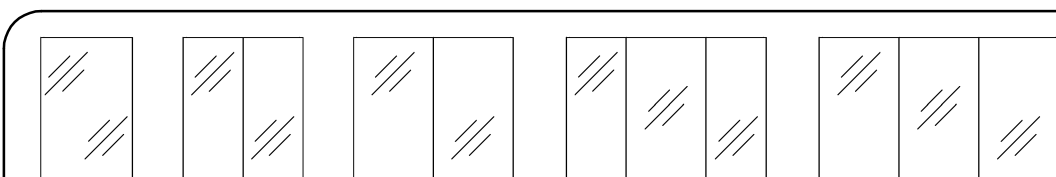
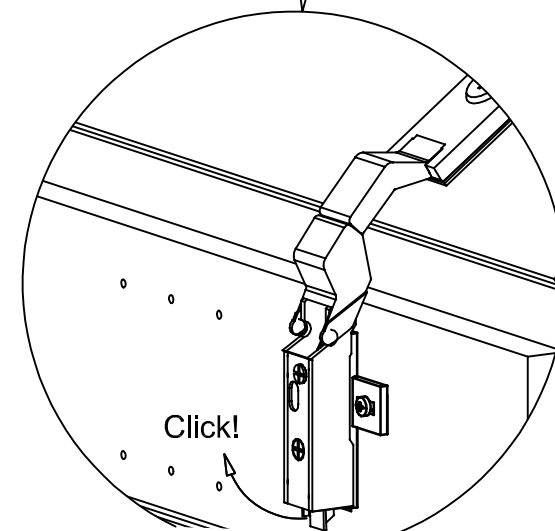

1.

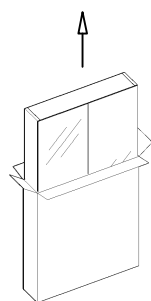
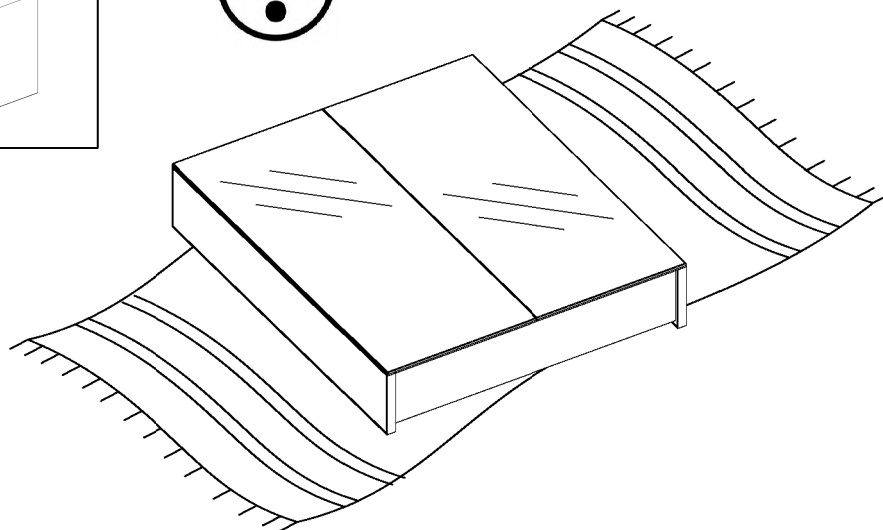

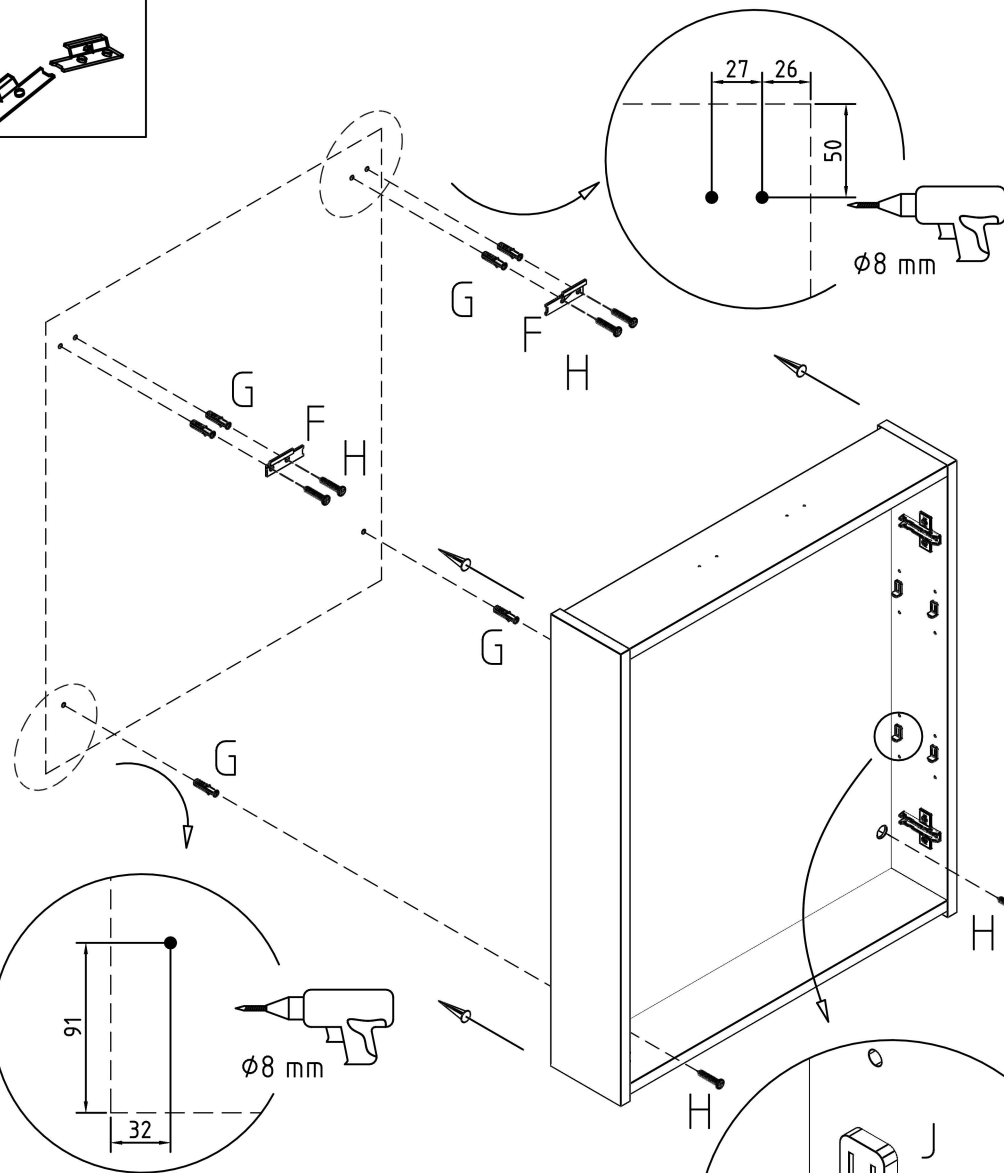
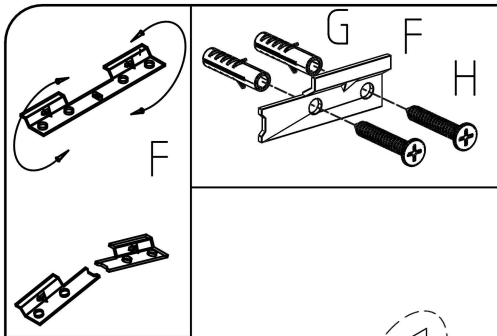

3.

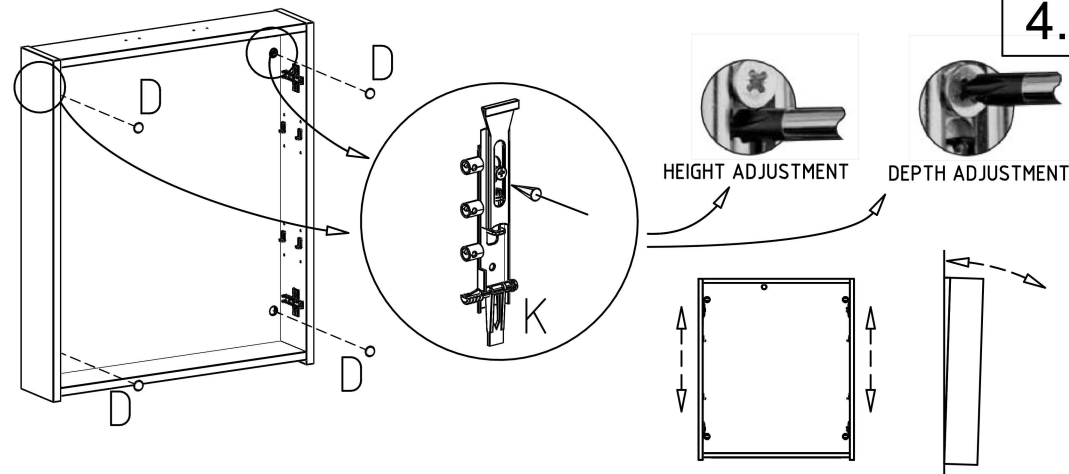

4.

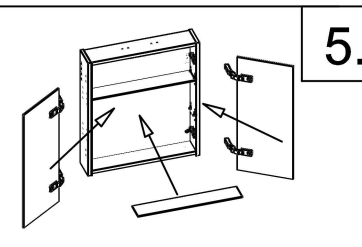

5.

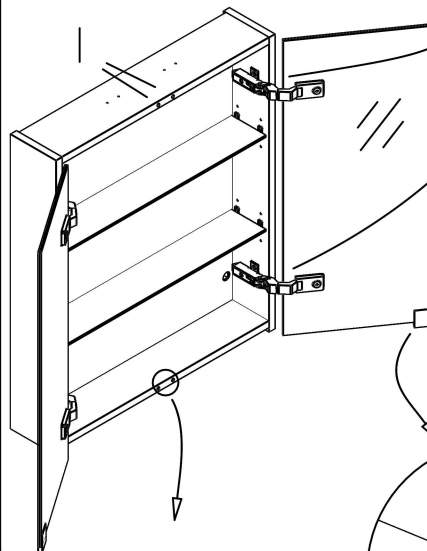

6.

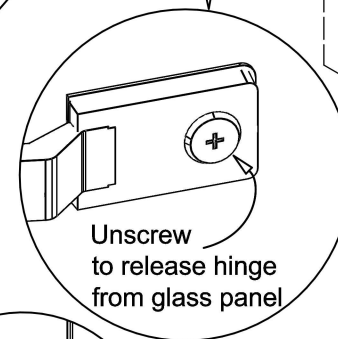
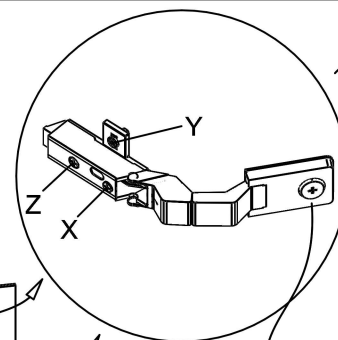

Unscrew
to release hinge
from glass panel

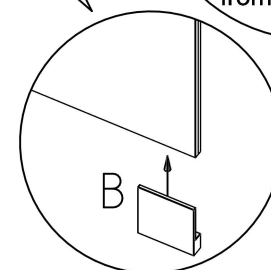

B

Video instruction for
cabinet installation



Optional luminaries

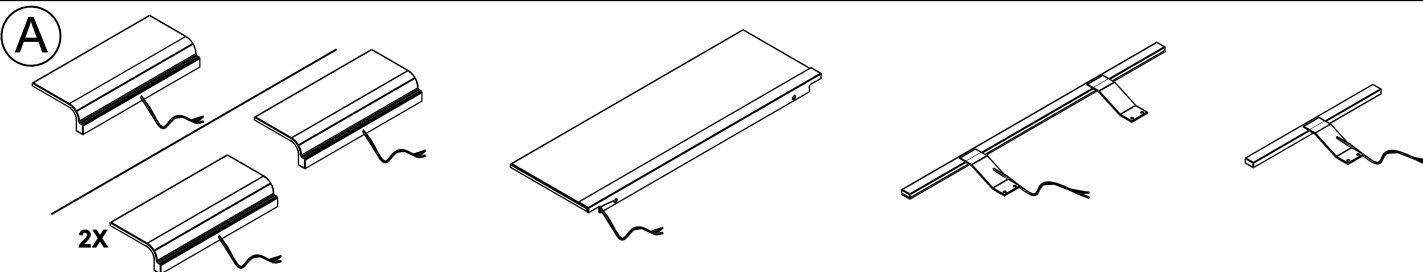

Optional underlight

(B)

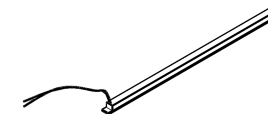

Option 1:

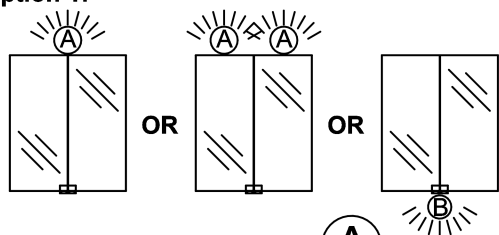

Video instruction for luminaire installation

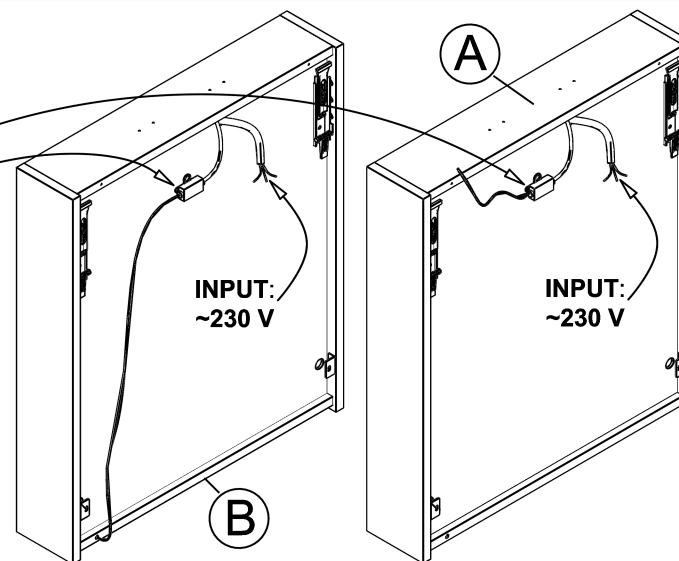
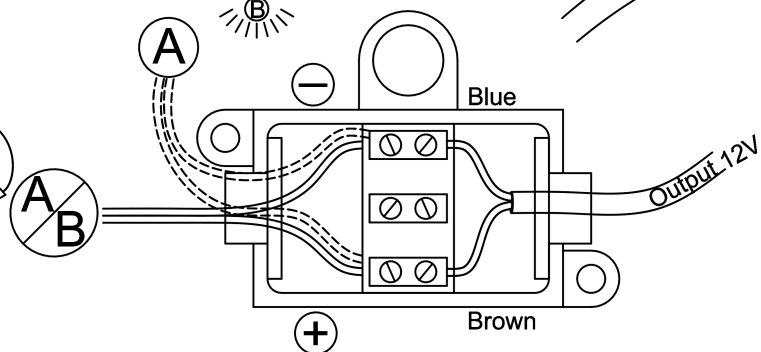

Distinguishing polarity:

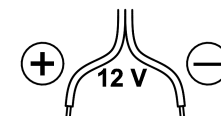

~ wire with color strip;
~ wire with writings;
~ dual color wire.

~ monochrome wire
without markings.

! All electrical work should be carried out only by a suitably qualified and competent person, in strict accordance with national safety regulations.

Option 2:

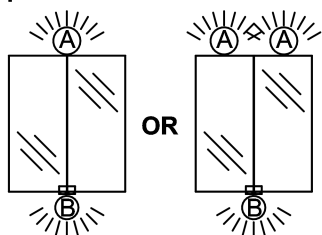

Video instruction for luminaire + underlight installation

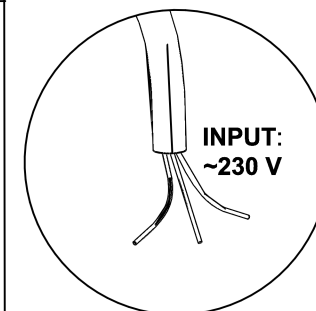
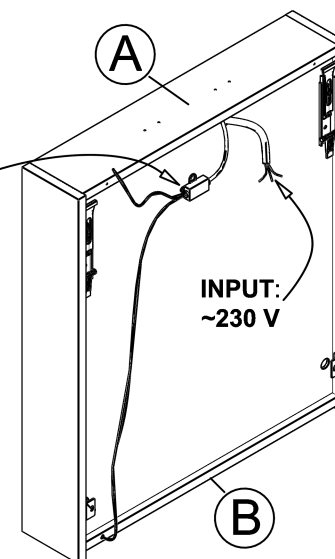
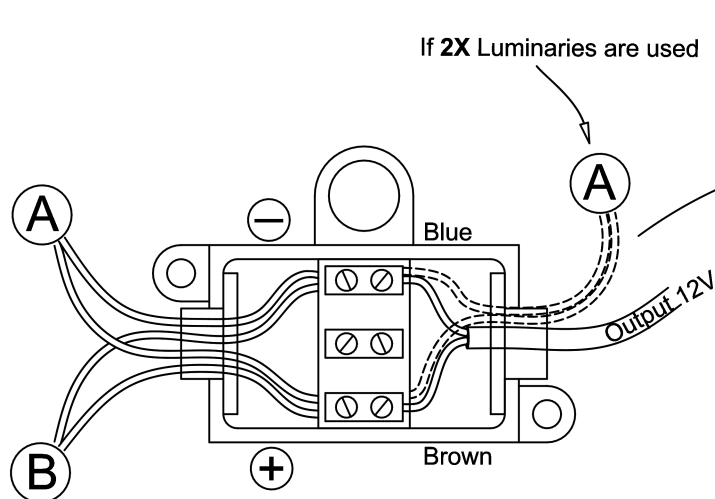

INPUT wiring:

Brown - Load
Blue - Neutral
Green / yellow - Ground